

TNW | M05

Instruction For Use



EN-Quick Start Guide

1. Gimbal Show APP



Scan Download
Gimbal Show APP



Scan the Code to View
APP User Manual

2. Recognize M05

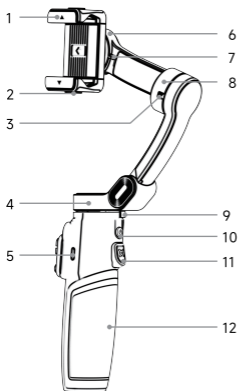

1. Phone holder
2. Accessory positioning seat
3. Pitch axis locking clip
4. Heading axis motor
5. Type-C charging port
6. Horizontal roller motor
7. Horizontal roller limit clip
8. Pitch axis motor
9. Heading axis locking clip
10. Stabilizer power button

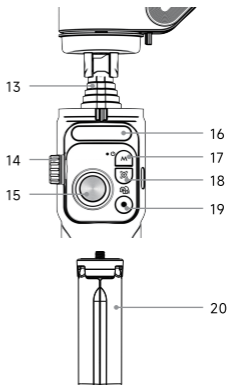

11. Trigger button
12. Handle
13. Aluminum alloy rod
14. Zoom/Multiplier control wheel
15. Joystick
16. Indicator lamp
17. M button/Remote control power button
18. Lockout button
19. Camera button
20. Tripod

3. Charging

When the M05 power is low, the red light of the power indicator flashes, and charge it with the Type-C charging cable provided in the package. The battery indicator light of M05 will flash with green while charging, and the battery indicator light will keep on green when it's fully charged.

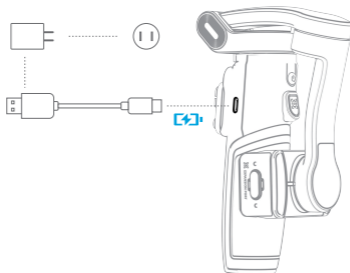

- ❗ 1. Please fully charge the M05 before use to ensure you can smoothly play it.
2. Please make sure the M05 has been turned off before charging.

4. Clamp Phone

1. Please refer the following step to unfold M05:
Open M05, and release the locking status of the heading axis, pitch axis.

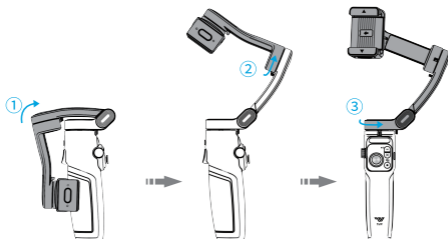

- ❗ Please refer to the diagram while operating to avoid damaging the device.

(Please make sure the stabilizer is fully unlocked before using it to avoid damaging the stabilizer motors)

2. Clamp the phone into the phone holder. (Pay attention to the installation direction of the phone to avoid blocking the lens).

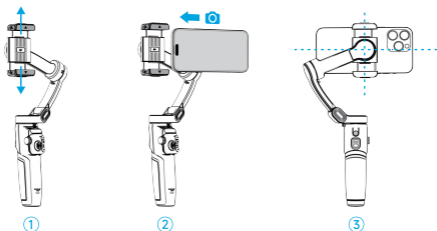

- ① 1. Make sure the phone is tightly attached to the surface of the phone holder while clamping the phone.
2. Try to ensure that the phone is in the middle of the phone clip in order to achieve optimal performance of the stabilizer.

5. Status Display

Displays wireless, stabilizer mode, remote control, battery level indicators.

📶 Wireless indicator light

| Status | Describe |
|---------------------|---------------|
| Blue light on | Connected |
| Blue light flashing | No connection |

🌀 Stabilizer mode indicator light

| Mode light (white light) | Describe |
|--------------------------|--|
| PF light on 🌀 | Semi-follow: The roll axis and pitch axis will keep balance, and the heading axis follows the subject motion. |
| AF light on 🌀 | Full follow: The roll axis will keep balance, and the pitch axis and heading axis will follow the subject motion. |
| AF light on 🏠 | Fully locked: All 3-axes remain balanced (suitable for linear motion shooting). |
| FV light on 🌀 | POV: First-person perspective. |
| PF+AF light on 🌀+🌀 | Inception space: Inception space, one click into the film. |
| PF fast blink 🌀 | Semi-follow Go Mode |
| AF fast blink 🌀 | Full follow Go Mode |

Remote control indicator light

| Status | Describe |
|--|-----------------------|
| Blue light on | Boot status |
| Blue light blinks twice | Press the key |
| Blue light blinks twice | Boot and gimbal merge |
| Red light display | Low power |
| Red and blue lights flashing alternately | Pairing |
| Blue light flashing for 3s | Pairing succeeded |

Battery indicator light





| Status | Describe |
|--|-----------------------|
| Green light on | Fully charged |
| Green light flashing | Charging |
| Green light on | 60~100% battery |
| Yellow light on | 20~60% battery |
| Red light on | Less than 15% battery |
| Red light flashing fast | Low battery power off |
| IRed and green lights flashing alternately | Pairing |
| Green light flashing for 3s | Pairing succeeded |

6.Key Function



M button/Remote control power button

Long press: Turn on/off

Click: Switch mode PF  -AF  -AL  -FV 

Two clicks: Horizontal/Vertical rmode switching

5 clicks: Pair with stabilizer



Lockout button

Click: Tracking with APP (Effective in APP)

Two clicks: Stabilizer forward correction

3 clicks: Spinshot

4 clicks: Backside correction

Long press: Lock mode

Click + Long press: Phone Go

(The torque and speed of motor will reach the maximum. It can follow the user with the highest speed to achieve the best shooting effect.)



Camera button

Click: Photo

Two clicks: Switch between taking photos and videos(Effective in APP)

3 clicks: Switching between front and rear cameras(Effective in APP)



Joystick

Push the controller up / down / left / right to control the stabilizer to rotate.

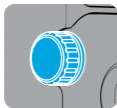

Zoom/Multiplier control wheel(Effective in APP)

Side turning switch

Click: Zoom/manual focus mode switching

Toggle up and down: Adjusting the focal length
(Some models do not support manual focus).



Stabilizer power button

Long press: Turn on/off

Click: Switch mode PF ↔ -AF ↔ -AL ↔ -FV ↔

Two clicks: Horizontal/Vertical mode switching
5 clicks: Pair with remote control
or AI tracking camera.



Trigger button

Click: Tracking with APP (Effective in APP)

Two clicks: Stabilizer forward correction

3 clicks: Spinshot

4 clicks: Backside correction

Long press: Lock mode

Click + Long press: Phone Go

(The torque and speed of motor will reach the maximum.
It can follow the user with the highest speed to achieve
the best shooting effect).

1. Some of the above buttons can only be used when the phone is connected to the stabilizer and running the "Gimbal Show" APP.
2. When the remote control and Stabilizer are separated, they switch on and off individually; And either party can leave the other on when they merge with the power on.

7.APP Connection

After activating the stabilizer, use your phone to search for "TNW M05-XXXXXX" and match it, or enter the "Gimbal Show" app to tap the device icon in the top left corner to pair. After successful pairing, the indicator light remains blue and the device icon turns blue.

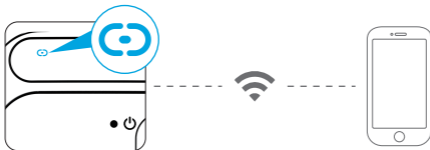

1. Paired with the customized app "Gimbal Show" for M05, you can better utilize the various functions of this stabilizer.
2. Please refer to the latest version of the "Gimbal Show" app. Any updates are subject to change without prior notice.

8.Magnetic Remote Control

Stabilizer can remove the remote control, the remote control aligned with the notch adsorption reset.

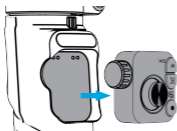

1. The remote control will follow the charging after reset.

9.AI Follow Camera (Buy Separately)

1. Pairing Instructions

1. Install the camera as shown, start the camera and stabilizer.

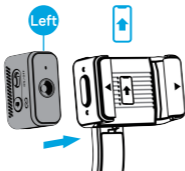

1. The AI camera must be installed on the left side of the position shown, otherwise it cannot be used normally.

- ② Click the camera gesture button and the stabilizer power button 5 times within 30s of booting to start pairing.

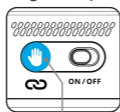

5 clicks on the camera gesture button

+



5 clicks on the stabilizer power button

- ③ Flashing green light indicates successful pairing.

2. Button Instructions

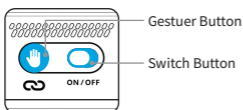

 Toggle: On/Off

 Click: Gesture on/off
5 clicks: Pairing

3. Indicator Light Instructions

| Status | Describe |
|---|-----------------------------------|
| Green light on | Power on Tracking + Gesture on |
| Blue light on | Tracking + Gesture off |
| Green light flashing | No tracking + Gesture on |
| Blue light flashing | No tracking + Gesture off |
| Red and green lights flashing alternately | Pairing |
| Green light flashing for 3 seconds | Pairing succeeded |

4. Gesture Operation Instructions

When operating, please face the front of the camera for accurate identification.

 **OK Gesture**
Start tracking
Protagonist mode



Double Eight Gesture
Composition tracking start
*After pause tracking, move to the designated location to make a double eight gesture

 **STOP Gesture**
Pause tracking



Double Thumb Gesture
Vertical and horizontal switchig
*After switching, the tracking state will enter pause

 **666 Gesture**
Take photos / Record videos
*It depends on the camera mode

- ⓘ After the target is briefly lost or blocked, it can still be retrieved within 3 seconds. If it exceeds 3 seconds, the target: needs to be relocked.

10. Magnetic Filling Light (Buy Separately)

1. Install the fill light according to the position shown in the illustration, the fill light blinks twice and is ready to use.

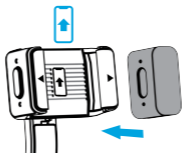

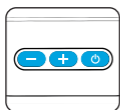

2. Button Instructions



 Click: Power on/Switching light modes(White, Warm, White+Warm)

Long press: Power off(Power off memory function, Power on default last setting)

 Click: Brightness plus (low, medium and high third gear)

 Click: Brightness reduction (low, medium and high third gear)

11. Comes with Telescopic Rod

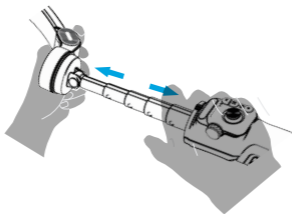

12. Folding Step

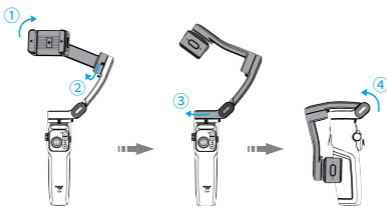

 Please refer to the diagram while operating to avoid damaging the device.

13. Specification Parameters

| Stabilizer | |
|----------------------------------|--|
| Product size | 174.5x106x65.5mm(Fold) |
| Extended length | 485mm |
| Product weight | 392g |
| Main materials | PC+ABS+PA66+Aluminum alloy |
| Structure rotation range | Course: 320° Roll: 345° Pitch: 320° |
| Control rotation angle | Course: 300° Roll: 325° Pitch: 80° |
| Wireless remote control distance | 10m |
| Applicable phone width | 50-90mm |
| Applicable phone thickness | ≤11mm |
| Applicable phone weight | ≤220g |
| Battery rated energy | 6.93Wh (900mAh) |
| Rated input | 5V-1.7A (Type-C) |
| Working current | 200mA (Approximate) |
| Working hours | 5h (Test reference value under balanced condition) |
| Tripod | |
| Product size | 32.5x32.5x95mm(Fold) |
| Product weight | 40g |
| Main materials | PA66 |
| Interface | 1/4" s Standard screw |

14. Security Profile

M05 is relatively precise, and users should have basic hands-on skills and safety knowledge, and need to use it carefully. Please read the instructions for using M05 first and familiarize yourself with the product's functions before using it. Incorrect operation will lead to product damage, property damage and even personal injury. This product is not suitable for children's use. To ensure that you can use M05 correctly and safely, please carefully read the instructions and safety summary before installing, setting up, and using it, and strictly follow the relevant instructions to install and use M05.

Warning

1. It is strictly prohibited to let the product come into contact with any liquid, and do not immerse the product in water or wet it. Do not use the product in rain or damp environments. After coming into contact with water inside the product, corrosion reactions may occur, causing the battery to self ignite and may even cause an explosion.
2. If the product catches fire, please immediately use water, mist sand, fire blanket, dry powder, or carbon dioxide fire extinguishers to extinguish the fire. Please choose the fire extinguishing method in the order recommended above based on the actual situation.
3. Please use the product in an environment with a temperature between -10°C and 45°C.

4. It is prohibited to disassemble the product in any way. If the battery is punctured during disassembly, it will lead to electrolyte leakage inside the battery, and even cause a fire or explosion.
5. Mechanical impact, rolling or throwing of products is prohibited. Do not place heavy objects on the product.
6. Do not heat the product. Do not place the product in the microwave oven or pressure cooking.
7. It is prohibited to place products near heat sources (such as stoves or heaters) or in cars on hot days. Do not store the product in an environment exceeding 60°C. The ideal storage environment temperature is 22°C to 28°C.
8. Do not store the battery for a long time after it has been completely discharged to prevent it from entering an over discharged state and causing damage to the battery cell, which will prevent it from being restored to use.

Take Care

1. M05 is a high-precision control device. Falling or being hit by external forces may cause damage to M05, leading to abnormal operation.
2. Make sure the gimbal won't get blocked by any external force when M05 is turned on.
3. M05 is not waterproof. Do not allow M05 to come into contact with any liquid or any liquid with any cleaning function. It is recommended to use a soft dry cloth to clean M05.
4. Please prevent M05 from dust and sand while using it.

Attention

1. Please turn off M05 before charging it. And disconnected the device and the charger after fully charged.
2. If the product is not used for more than 10 days, please discharge the battery to 40% - 65% of its capacity for storage, which can extend the battery's service life.
3. Recharge and discharge every 3 months to maintain battery activity.



MADE IN CHINA